



GOLDLINE

ROYAL APARTMENTS

2, 3 & 4 Bedrooms Luxurious Apartments

Located on
Block 19 Gulistan-e-Johar,
Adjacent to Askari IV
Near Johar Mor, Karachi



PROPERTIES



EXECUTIVE APARTMENTS CATEGORIES

CATEGORY "D" 3 ROOMS EXECUTIVE APARTMENTS

CATEGORY "C" 2 BEDROOMS APARTMENTS

CATEGORY "C-1" 2 BEDROOMS APARTMENTS

CATEGORY "C-2" 2 BEDROOMS APARTMENTS

CATEGORY "C-3" 2 BEDROOMS APARTMENTS

CATEGORY "C-4" 2 BEDROOMS APARTMENTS

CATEGORY "B" 3 BEDROOMS EXECUTIVE APARTMENTS

CATEGORY "B-1" 3 BEDROOMS EXECUTIVE APARTMENTS

CATEGORY "A" 4 BEDROOMS EXECUTIVE APARTMENTS

- Banquet
- 24 Hours CCTV
- Modern Corridor
- Stand-By Generator
- Indoor Games
- Living Room
- Reception Area
- Modern Bedrooms, Drawing & Bathrooms
- Covered Car Parking

AMENITIES



CATEGORY "D" 3 ROOMS EXECUTIVE APARTMENTS

INTERNAL PLAN



CATEGORY “D” 3 ROOMS EXECUTIVE APARTMENTS

PAYMENT PLAN

Description	Amount
At The Time Of Booking	600,000
After 30 Days	450,000
After 60 Days	450,000
After 90 Days	450,000
36 Monthly Installments of (25,000)	<div>25,000 x 36</div> <div>900,000</div>
6 Half Yearly Installments of (100,000)	<div>100,000 x 6</div> <div>600,000</div>
On Possession	230,000
CASH PAYABLE	3,680,000
HBFC LOAN	2,110,000
TOTAL COST OF UNIT	5,790,000

EXTRA CHARGES

CORNER	300,000
ROAD FACING	300,000
ROOF CHARGES	1,000,000
HBFC	2,110,000

IMPORTANT NOTE

1. All instalments must be paid by the allottee strictly as per schedule agreed by the allottee, from 1st to 10th of each month and the allottee shall abide by the terms and conditions of the booking application form.
2. All the extra charges will be payable within 180 days from the date of booking.
3. The allocation of unit shall remain provisional unit the company receives full and final payment.
4. Documentation charges of lease, load and connection charges for Gas, Electricity, Water & sewerage etc will be charged as ectra demanded by the companay as these charges are not included in the above mentiond cost.
5. All discounts are subject to regular payment as per decide schedule.

Read, Understood & Accepted

Signature

CATEGORY "C" 2 BEDROOMS APARTMENTS

INTERNAL PLAN



CATEGORY “C” 2 BEDROOMS APARTMENTS

PAYMENT PLAN

Description	Amount
At The Time Of Booking	650,000
After 30 Days	600,000
After 60 Days	600,000
After 90 Days	600,000
36 Monthly Installments of (45,000)	<div>45,000 x 36</div> <div>1,620,000</div>
6 Half Yearly Installments of (165,000)	<div>165,000 x 6</div> <div>990,000</div>
On Possession	340,000
CASH PAYABLE	5,400,000
HBFC LOAN	2,900,000
TOTAL COST OF UNIT	8,300,000

EXTRA CHARGES

West Open	300,000
CORNER	300,000
ROAD FACING	300,000
ROOF CHARGES	1,500,000
HBFC	2,900,000

IMPORTANT NOTE

1. All instalments must be paid by the allottee strictly as per schedule agreed by the allottee, from 1st to 10th of each month and the allottee shall abide by the terms and conditions of the booking application form.
2. All the extra charges will be payable within 180 days from the date of booking.
3. The allocation of unit shall remain provisional unit the company receives full and final payment.
4. Documentation charges of lease, load and connection charges for Gas, Electricity, Water & sewerage etc will be charged as extra demanded by the company as these charges are not included in the above mentioned cost.
5. All discounts are subject to regular payment as per decide schedule.

Read, Understood & Accepted

Signature

CATEGORY "C-1" 2 BEDROOMS APARTMENTS

INTERNAL PLAN



CATEGORY “C-1” 2 BEDROOMS APARTMENTS

PAYMENT PLAN

Description	Amount
At The Time Of Booking	650,000
After 30 Days	600,000
After 60 Days	600,000
After 90 Days	600,000
36 Monthly Installments of (45,000)	<div>45,000 x 36</div> <div>1,620,000</div>
6 Half Yearly Installments of (165,000)	<div>165,000 x 6</div> <div>990,000</div>
On Possession	340,000
CASH PAYABLE	5,400,000
HBFC LOAN	2,900,000
TOTAL COST OF UNIT	8,300,000

EXTRA CHARGES

West Open	300,000
CORNER	300,000
ROAD FACING	300,000
ROOF CHARGES	1,500,000
HBFC	2,900,000

IMPORTANT NOTE

1. All instalments must be paid by the allottee strictly as per schedule agreed by the allottee, from 1st to 10th of each month and the allottee shall abide by the terms and conditions of the booking application form.
2. All the extra charges will be payable within 180 days from the date of booking.
3. The allocation of unit shall remain provisional unit the company receives full and final payment.
4. Documentation charges of lease, load and connection charges for Gas, Electricity, Water & sewerage etc will be charged as extra demanded by the company as these charges are not included in the above mentioned cost.
5. All discounts are subject to regular payment as per decide schedule.

Read, Understood & Accepted
Signature

CATEGORY "C-2" 2 BEDROOMS APARTMENTS

INTERNAL PLAN



CATEGORY “C-2” 2 BEDROOMS APARTMENTS

PAYMENT PLAN

Description	Amount
At The Time Of Booking	650,000
After 30 Days	600,000
After 60 Days	600,000
After 90 Days	600,000
36 Monthly Installments of (45,000)	<div>45,000 x 36</div> <div>1,620,000</div>
6 Half Yearly Installments of (165,000)	<div>165,000 x 6</div> <div>990,000</div>
On Possession	340,000
CASH PAYABLE	5,400,000
HBFC LOAN	2,900,000
TOTAL COST OF UNIT	8,300,000

EXTRA CHARGES

West Open	300,000
CORNER	300,000
ROAD FACING	300,000
ROOF CHARGES	1,500,000
HBFC	2,900,000

IMPORTANT NOTE

1. All instalments must be paid by the allottee strictly as per schedule agreed by the allottee, from 1st to 10th of each month and the allottee shall abide by the terms and conditions of the booking application form.
2. All the extra charges will be payable within 180 days from the date of booking.
3. The allocation of unit shall remain provisional unit the company receives full and final payment.
4. Documentation charges of lease, load and connection charges for Gas, Electricity, Water & sewerage etc will be charged as extra demanded by the company as these charges are not included in the above mentioned cost.
5. All discounts are subject to regular payment as per decided schedule.

Read, Understood & Accepted
Signature

CATEGORY "C-3" 2 BEDROOMS APARTMENTS

INTERNAL PLAN



CATEGORY “C-3” 2 BEDROOMS APARTMENTS

PAYMENT PLAN

Description	Amount
At The Time Of Booking	650,000
After 30 Days	600,000
After 60 Days	600,000
After 90 Days	600,000
36 Monthly Installments of (45,000)	<div>45,000 x 36</div> <div>1,620,000</div>
6 Half Yearly Installments of (165,000)	<div>165,000 x 6</div> <div>990,000</div>
On Possession	340,000
CASH PAYABLE	5,400,000
HBFC LOAN	2,900,000
TOTAL COST OF UNIT	8,300,000

EXTRA CHARGES

West Open	300,000
CORNER	300,000
ROAD FACING	300,000
ROOF CHARGES	1,500,000
HBFC	2,900,000

IMPORTANT NOTE

1. All instalments must be paid by the allottee strictly as per schedule agreed by the allottee, from 1st to 10th of each month and the allottee shall abide by the terms and conditions of the booking application form.
2. All the extra charges will be payable within 180 days from the date of booking.
3. The allocation of unit shall remain provisional unit the company receives full and final payment.
4. Documentation charges of lease, load and connection charges for Gas, Electricity, Water & sewerage etc will be charged as ectra demanded by the companay as these charges are not included in the above mentiond cost.
5. All discounts are subject to regular payment as per decide schedule.

Read, Understood & Accepted
Signature

CATEGORY "C-4" 2 BEDROOMS APARTMENTS

INTERNAL PLAN



CATEGORY “C-4” 2 BEDROOMS APARTMENTS

PAYMENT PLAN

Description	Amount
At The Time Of Booking	650,000
After 30 Days	600,000
After 60 Days	600,000
After 90 Days	600,000
36 Monthly Installments of (45,000)	<div>45,000 x 36</div> <div>1,620,000</div>
6 Half Yearly Installments of (165,000)	<div>165,000 x 6</div> <div>990,000</div>
On Possession	340,000
CASH PAYABLE	5,400,000
HBFC LOAN	2,900,000
TOTAL COST OF UNIT	8,300,000

EXTRA CHARGES

West Open	300,000
CORNER	300,000
ROAD FACING	300,000
ROOF CHARGES	1,500,000
HBFC	2,900,000

IMPORTANT NOTE

1. All instalments must be paid by the allottee strictly as per schedule agreed by the allottee, from 1st to 10th of each month and the allottee shall abide by the terms and conditions of the booking application form.
2. All the extra charges will be payable within 180 days from the date of booking.
3. The allocation of unit shall remain provisional unit the company receives full and final payment.
4. Documentation charges of lease, load and connection charges for Gas, Electricity, Water & sewerage etc will be charged as ectra demanded by the companay as these charges are not included in the above mentiond cost.
5. All discounts are subject to regular payment as per decide schedule.

Read, Understood & Accepted
Signature

CATEGORY "B" 3 BEDROOMS EXECUTIVE APARTMENTS

INTERNAL PLAN



CATEGORY “B” 3 BEDROOMS EXECUTIVE APARTMENTS

PAYMENT PLAN

Description	Amount
At The Time Of Booking	1,000,000
After 30 Days	875,000
After 60 Days	875,000
After 90 Days	875,000
36 Monthly Installments of (75,000)	$\frac{75,000 \times 36}{2,700,000}$
6 Half Yearly Installments of (320,000)	$\frac{320,000 \times 6}{1,920,000}$
On Possession	655,000
CASH PAYABLE	8,900,000
HBFC LOAN	4,400,000
TOTAL COST OF UNIT	13,300,000

EXTRA CHARGES

CORNER	300,000
ROAD FACING	300,000
ASKARI FACING	300,000
ROOF CHARGES	2,000,000
HBFC	4,400,000

IMPORTANT NOTE

1. All instalments must be paid by the allottee strictly as per schedule agreed by the allottee, from 1st to 10th of each month and the allottee shall abide by the terms and conditions of the booking application form.
2. All the extra charges will be payable within 180 days from the date of booking.
3. The allocation of unit shall remain provisional unit the company receives full and final payment.
4. Documentation charges of lease, load and connection charges for Gas, Electricity, Water & sewerage etc will be charged as extra demanded by the company as these charges are not included in the above mentioned cost.
5. All discounts are subject to regular payment as per decided schedule.

Read, Understood & Accepted

Signature

CATEGORY "B-1" 3 BEDROOMS EXECUTIVE APARTMENTS

INTERNAL PLAN



CATEGORY “B-1” 3 BEDROOMS EXECUTIVE APARTMENTS

PAYMENT PLAN

Description	Amount
At The Time Of Booking	800,000
After 30 Days	850,000
After 60 Days	850,000
After 90 Days	850,000
36 Monthly Installments of (65,000)	$\frac{65,000 \times 36}{2,340,000}$
6 Half Yearly Installments of (300,000)	$\frac{300,000 \times 6}{1,800,000}$
On Possession	610,000
CASH PAYABLE	8,100,000
HBFC LOAN	4,400,000
TOTAL COST OF UNIT	12,500,000

EXTRA CHARGES	
West Open	300,000
CORNER	300,000
ROAD FACING	300,000
ASKARI FACING	300,000
ROOF CHARGES	2,000,000
HBFC	4,400,000

- IMPORTANT NOTE**
1. All instalments must be paid by the allottee strictly as per schedule agreed by the allottee, from 1st to 10th of each month and the allottee shall abide by the terms and conditions of the booking application form.
 2. All the extra charges will be payable within 180 days from the date of booking.
 3. The allocation of unit shall remain provisional unit the company receives full and final payment.
 4. Documentation charges of lease, load and connection charges for Gas, Electricity, Water & sewerage etc will be charged as extra demanded by the company as these charges are not included in the above mentioned cost.
 5. All discounts are subject to regular payment as per decided schedule.

Read, Understood & Accepted

Signature

CATEGORY "A" 4 BEDROOMS EXECUTIVE APARTMENTS

INTERNAL PLAN

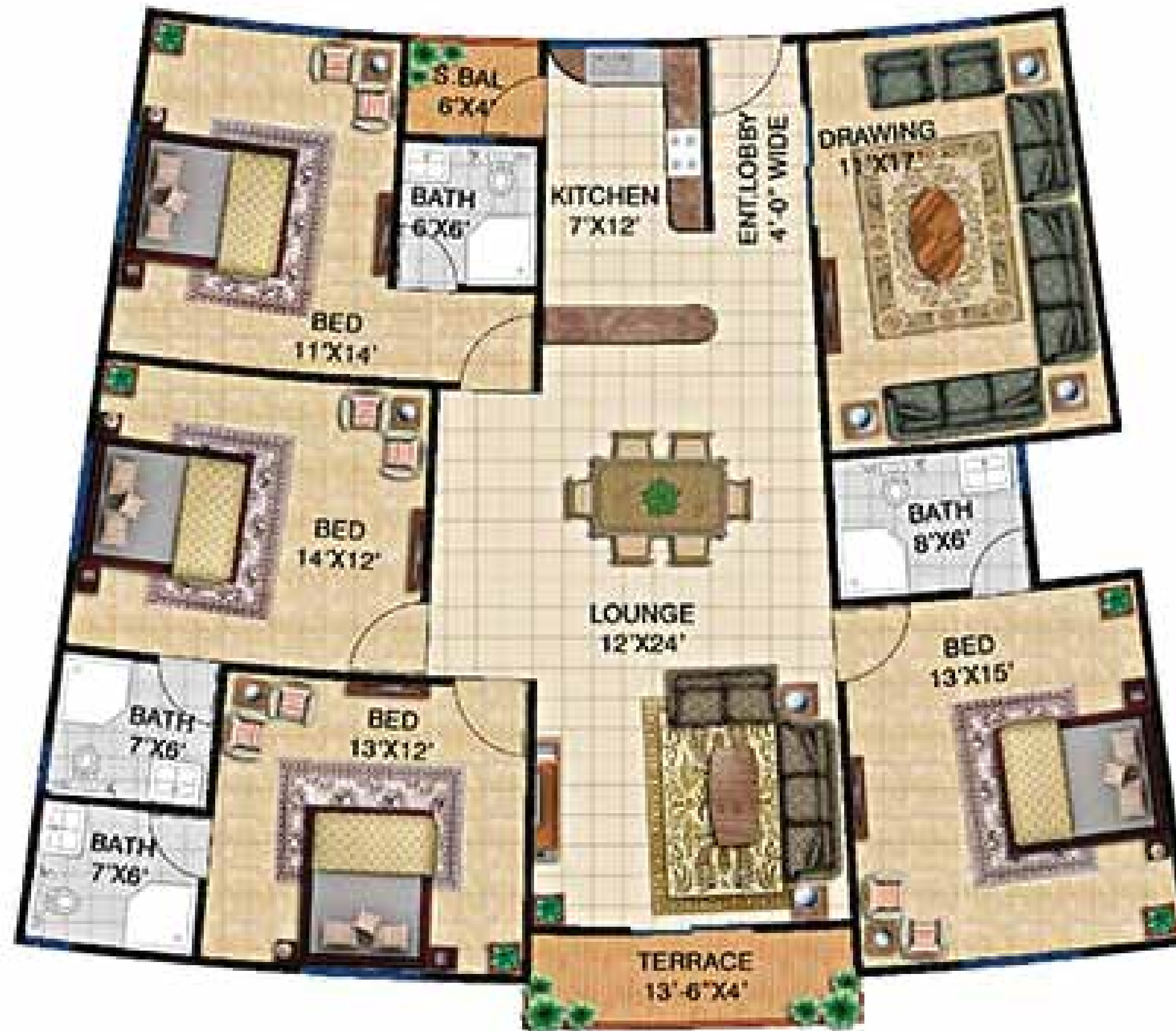

CATEGORY “A” 4 BEDROOMS EXECUTIVE APARTMENTS

PAYMENT PLAN

Description	Amount
At The Time Of Booking	1,200,000
After 30 Days	1,050,000
After 60 Days	1,050,000
After 90 Days	1,050,000
36 Monthly Installments of (90,000)	$\frac{90,000 \times 36}{3,240,000}$
6 Half Yearly Installments of (300,000)	$\frac{300,000 \times 6}{1,800,000}$
On Possession	810,000
CASH PAYABLE	10,200,000
HBFC LOAN	4,600,000
TOTAL COST OF UNIT	14,800,000

EXTRA CHARGES

CORNER	300,000
ROAD FACING	300,000
ASKARI FACING	300,000
ROOF CHARGES	2,500,000
HBFC Loan	4,600,000

IMPORTANT NOTE

1. All instalments must be paid by the allottee strictly as per schedule agreed by the allottee, from 1st to 10th of each month and the allottee shall abide by the terms and conditions of the booking application form.
2. All the extra charges will be payable within 180 days from the date of booking.
3. The allocation of unit shall remain provisional unit the company receives full and final payment.
4. Documentation charges of lease, load and connection charges for Gas, Electricity, Water & sewerage etc will be charged as extra demanded by the company as these charges are not included in the above mentioned cost.
5. All discounts are subject to regular payment as per decided schedule.

Read, Understood & Accepted

Signature



GOLDLINE
ROYAL APARTMENTS

THANK YOU

0332-3447830



PROPERTIES